

ProDVX F-250 HD MP Quick Manual

Features:

1. Support: Photo, Music, Video File, Viewer Function
2. Supported File Format:
MPGI,MEPGII,MEPG4+XVID(SP,ASP),DIVX(HD1080P),H264(SP/MP/HP),
H.263(BP) ,WMV9/VC-1(SP/MP/AP)/RMVB(V8/V9)
3. JPEG High Resolution support: 1900*1600(max)
4. Support Auto-play
5. Infrared Remote Control
6. OSD Multi-languages: Chinese, Traditional Chinese, English, Russian, Portuguese, Spanish, Korea, Hungarian.
7. Support Plug & Play
8. Auto Power on/ off (Timer Setup Media Player Function)
9. Memory support: SD card and USB flash Memory, (USB auto copy to SD card function)
10. Support input: VGA Input /AV input/Media Play (last memory for Power off)
11. MOVIE: Repeat one last memory support (Support repeat mode in Movie function)

Other Specifications:

1. Power Requirement: DC 12V/ 2A
2. Output Signal: Composite Video (NTSC/ PAL) VGA (DSB-15pin), HDMI
3. Head Phone support
4. Auto play from SD & USB
5. Interactivity by external button box: File name Top,1~12 support button Function

Remote control

POWER	POWER ON/OFF
SETUP	Change settings
DISPLAY	Choose Function
CARD Selection	Choose a different memory card
MUSIC	Go to and display music files
PHOTO	Go to and display photo files
MOVIE	Go to and display movie files
FILE	Go to file library (all files)
ROTATE	Rotate photo 0/90/270 degrees
ZOOM	Zoom*2/*4/*8/*16 time
REPEAT	Play File repeat unit Stopped
Count	No function
REW ◀◀	Rewind movies
FF ▶▶	Forward movies
PREV ◻◀◀	Go to next file
Next ▶▶◻	Go to next file
+(VOLUME)	Raise volume
-(VOLUME)	Lower volume
MUTE	Mute volume
Screen	Choose Screen (Full screen/4:3/16:9)
↑	Move up
SLIDE Interval	Change slide show 1,3,5,7,10,15 sec.
←	Move left
PLAY/PAUSE ▶	PLAY/PAUSE, confirm selection
→	Move right
↓	Move down
STOP	Stop the selection file action
RETURN	“Return” Function
Clock	Show time and calendar
1,2,~8,9,0	Number Key
COPY	HDMI/VGA/AV Change
AUTO	No Function
VGA	VGA function
HDMI	HDMI function
AV	AV function

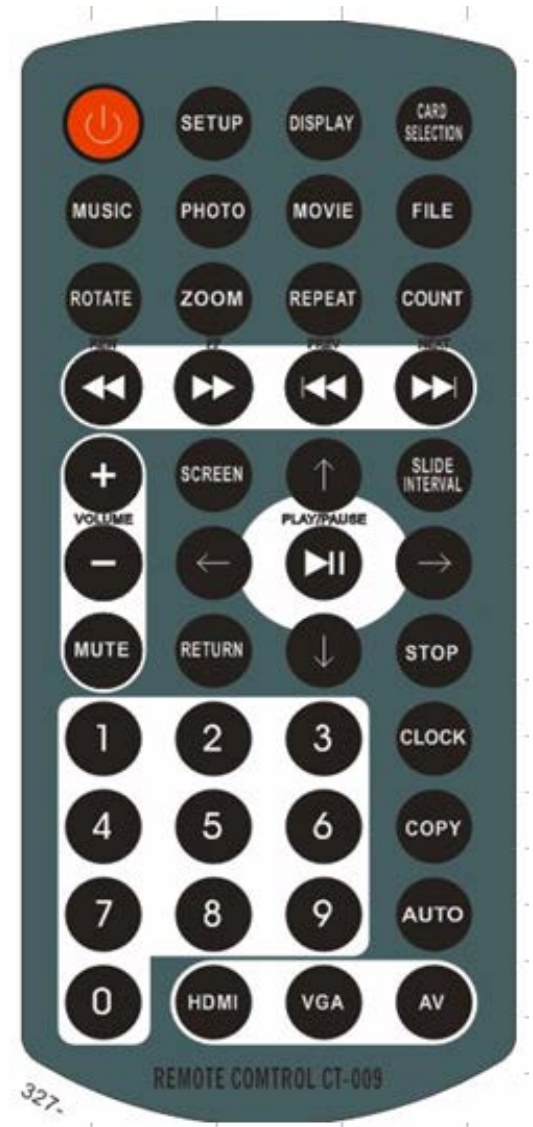

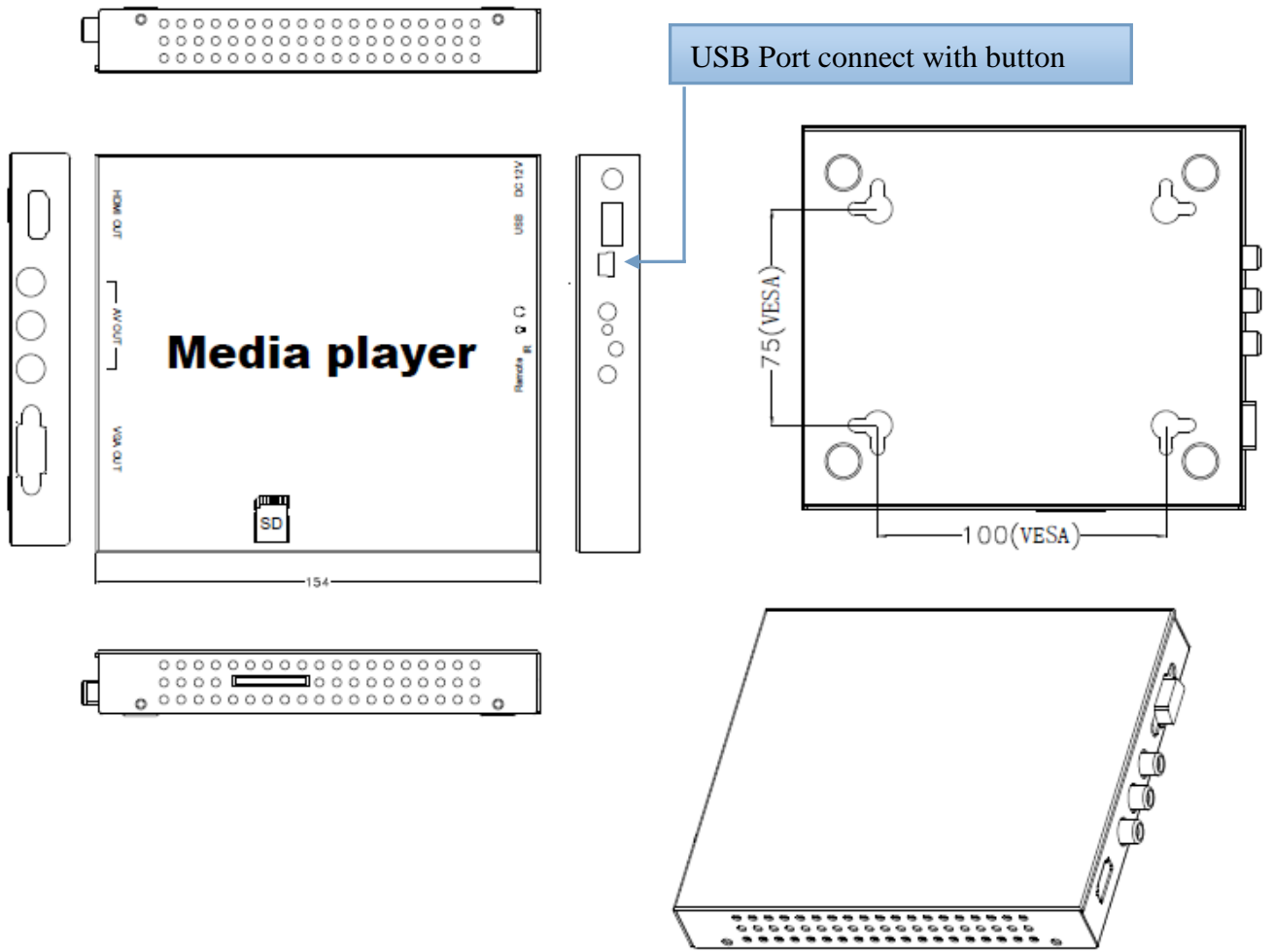

Insert the power plug into the media player, the below screen will appear.
The media player has the status “LOADING” now.

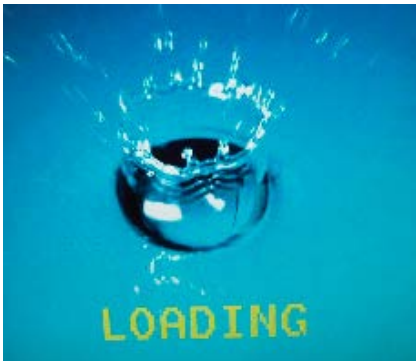

If you have inserted an SD card or USB stick the media player will automatically start to play the content.

To manually start playing content press on the Remote control the “Card Selection” button.

- (1) USB DISK (USB HDDd or PC connect)
- (2) SD Card

Media Play Function select

Press the “Return“ button the Main page is then shown.

You can select one of the following options:

- Movie
- Picture
- Music
- Setting
- Explore

If you choose the Movie Function and Press Play button, you can choose to play either from USB memory or SD card memory

Remoter control “Card selection”

Press “Card Selection” Then you can choose to Play content from SD card or USB Stick.

Press remote control “SETUP” button:

- (1) Output: PAL/NTSC For AV signal
- HDMI-720P(50HZ) For HDMI signal
 HDMI-720P(60HZ)
 HDMI-1080I(50HZ)
 HDIM-1080I(60HZ)
 HDMI-1080P(50HZ)
 HDMI-1080P(60HZ)
- VGA(1920*1080) For VGA signal
 VGA(1024*768)
 VGA(1366*768)

(2)Language:

Chinese/Traditional Chinese/English /Russian/Portuguese/Spanish/Korean/Hungarian

(3) System Play Mode:

A. Mix

The Media player will cycle Auto play. It can play continue movie content before JPEG content.

B. Movie

The media player only can cycle play MOVIE Content.

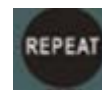

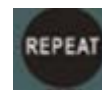
If you want to play one file ,then press on the remote control the  button, you can than change the play mode:

- (1) Repeat ALL
- (2) Repeat One

C. JPEG

The media player only play JPEG content

For the below mentioned functions the optional button box is required

D. 10key 123456

File name: TOP/1/2/3/4/5/6/7/8/9/10 (No.11) is “Stop” key (No.12) key is return “TOP”

After power on the media player will auto play TOP file.

If you press “1” button the media player will change to play “1” file If you press “7” button, then machine will change play “7” file. After finishing the file, it will continue to play the TOP file.

E. 10key 112233

File name: TOP/1/2/3/4/5/6/7/8/9/10 (No.11) is “Stop” key (No.12) key is return “TOP”

After power on the media player will auto play TOP file.

If you press “1” button the media player will start to play to play “1” file continuously. Until you press “3” file as an example then it will continuously play file “3”.

F. 10key 102030

File name: TOP/1/2/3/4/5/6/7/8/9/10 (No.11) is “Stop” key (No.12) key is return “TOP”

After power on the media player will auto play TOP file.

If you press “1” button the media player will start to play to play “1” file.

Pressing any other button will have no effect. It will finish to play the “1” file before starting the TOP file again.

G. 12 key 123456

File name: TOP/1/2/3/4/5/6/7/8/9/10/11/12

After power on the media player will auto play TOP file.

If you press “1” button the media player will change to play “1” file If you press “7” button, then machine will change play “7” file. After finishing the file, it will continue to play the TOP file.

H. 12.key 112233

File name: TOP/1/2/3/4/5/6/7/8/9/10/11/12

After power on the media player will auto play TOP file.

If you press “1” button the media player will start to play to play “1” file continuously. Until you press “3” file as an example then it will continuously play file “3”.

I. 12key 102030

File name: TOP/1/2/3/4/5/6/7/8/9/10/11/12

After power on the media player will auto play TOP file.

If you press "1" button the media player will start to play to play "1" file.

Pressing any other button will have no effect. It will finish to play the "1" file before starting the TOP file again.

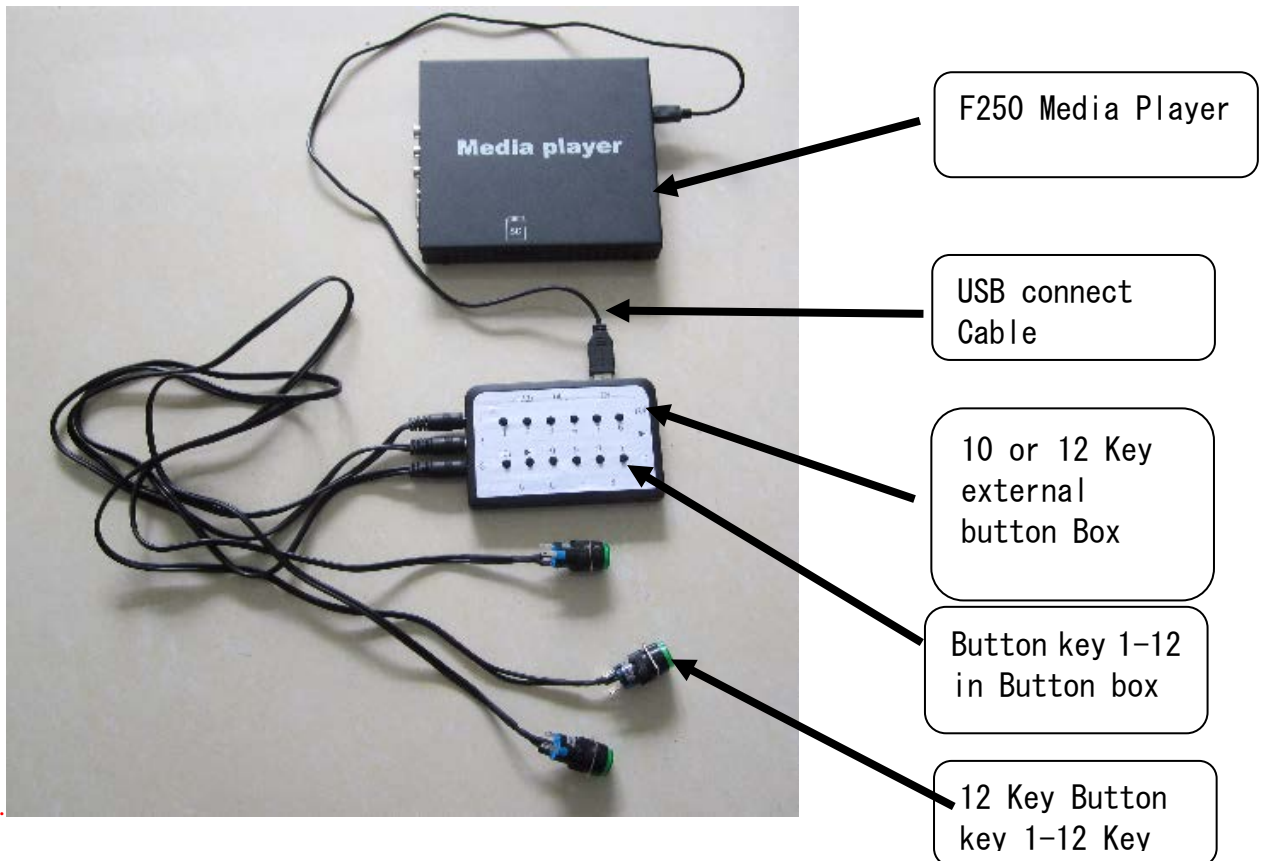

- (4)RTC Config
- (5)Power Config
- (6)KeyTone on/off
- (7)Software Version
- (8)Restore default

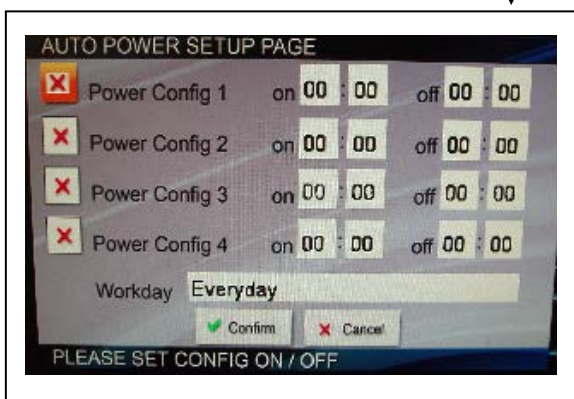
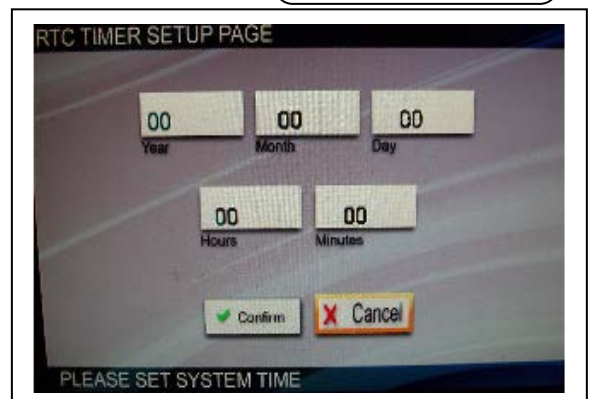

How to Auto Copy from USB to SD card?

USB Stick and the SD Card are both connected (inserted) to the Media Player. After that power on the media player.

The media player will “Auto Copy” the content on the USB stick to the SD card. (it will replace the content.

How to play content from the USB Stick?

If you insert the USB stick after the SD card, then the media player will change to play the USB stick files.